

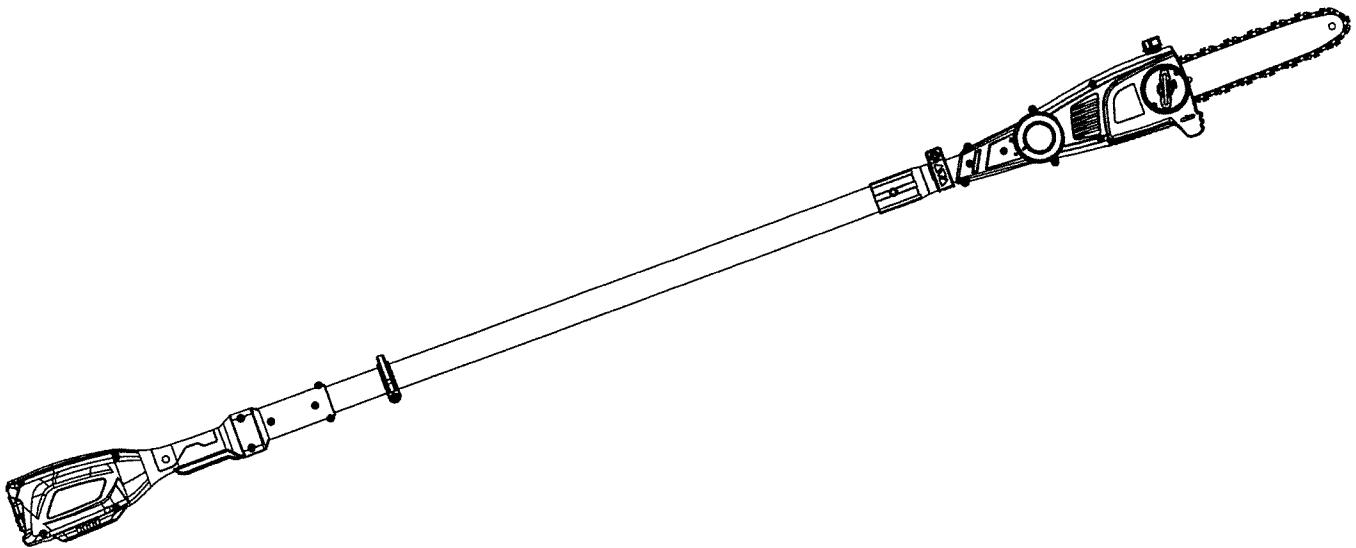

58V MAX LITHIUM ION CORDLESS POLE SAW

Operator's manual
Model: CSPX5-M



For customer support, please call 1-800-261-3981 or send email to:

support@senixtools.com

SAVE THIS MANUAL FOR FUTURE REFERENCE.

PARTS

EXPLODED VIEW

For replacement parts, email: parts@SENIXtools.com.

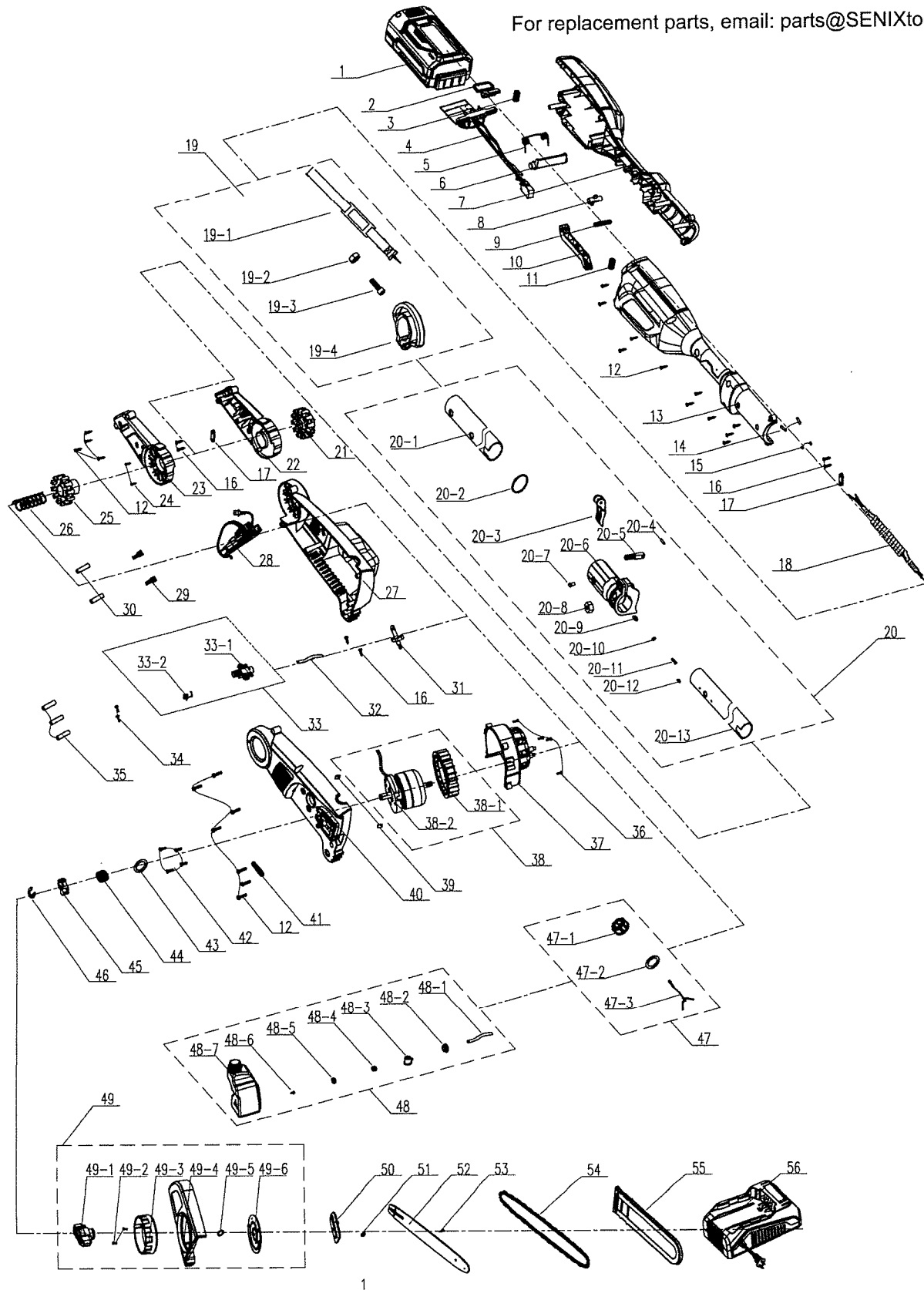

No.	Part #	Description	Qty.
1		Battery (2Ah)	1
2		Battery Latch	1
3		Button Spring	1
4		Electronic Components	1
5		Double Torsion Spring	1
6		Shaft	1
7		Left Handle	1
8		Safety	1
9		Spring	1
10		Trigger	1
11		Trigger Spring	1
12		Self Tapping Screw	22
13		Right handle	1
14		Heat Shrinkable Tube	1
15		Copper Strip	16
16		Self Tapping Screw	6
17		Cable Clamp	2
18		Spring Connecting Line	1
19		Telescoping Clamp	1
19-1		Brace	1
19-2		Hexagon Nut	1
19-3		Pan Head Screws	1
19-4		Brace Ring	1
20		Tube Assembly	1
20-1		Bassoon	1
20-2		Large Ring	1
20-3		Telescoping Clamp	1
20-4		Cylindrical Pin	1
20-5		Quick Clamping Adjusting Bolt	1
20-6		Connecting Brac	1
20-7		Fixed Pin	2
20-8		Locking Nut	1
20-9		Flat Gasket	1
20-10		Locking Nut	1
20-11		Countersunk Head Screws	1
20-12		Washer	1
20-13		In Pipe	1
21		Button	1
22		Connecting Handle Of Left Casing	1
23		Connecting Handle Of Right Casing	1
24		Self Tapping Screw	2
25		Driven Button	1
26		Steering Button Spring	1
27		Left Housing	1
28		Electronic Components	1

No.	Part #	Description	Qty.
29		Female Terminal	2
30		Heat Shrinkable Tube (Female)	1
31		Nozzle Assembly	1
32		Transparent Oil Tube	1
33		Oil Pump Assembly	1
33-1		Oil Pump Assembly	1
33-2		Oil Pump Tension Spring	1
34		Flange Tapping Screw	2
35		Heat Shrinkable Tube	1
36		Self Tapping Screw	4
37		Motor Cover	1
38		Motor Assembly	1
38-1		Fan Blade	1
38-2		Brushless Motor	1
39		Closing Plug	2
40		Right Housing	1
41		Oil Feed Seal	1
42		Countersunk Head Screws	4
43		Felted Wool	1
44		Tensioning Spring	1
45		Sprocket	1
46		Split Washer	1
47		Oil Box Cap Assembly	1
48		Oil Box Assembly	1
48-1		Transparent Oil Tube	1
48-2		Oil Tank Joint Rubber Sleeve	1
48-3		Oil Tank Delivery Connection	1
48-4		Sponge	1
48-5		Oil Box Joint Core Plug	1
48-6		Valve	1
48-7		Oil Tank	1
49		End Cap Assembly	1
49-1		Knob	1
49-2		Machine Screw	2
49-3		Adjusting Knob	1
49-4		End Cover	1
49-5		Axis With Circlips	1
49-6		Circle Wheel	1
50		Push Pedal	1
51		Seal Ring	1
52		Guide Bar	1
53		Pan Head Screws	1
54		Chain Saw	1
55		Guide Bar Sleeve	1
56		Charger	1